

Notes:
 Swept path analysis
 Manual override of rear axle steering has been used for part of this assessment.
 Autotrack standard library vehicles have been modified by SLR Consulting with regards to length and load carried, turning properties have not been modified.

- Legend:**
- Land where the applicant has ownership or beneficial interest
 - Planning application boundary
 - Proposed site access road
 - Proposed new haul road (General construction traffic)
 - Proposed new haul road (Abnormal load deliveries only)
 - Visibility Splay
 - Excluded from land where the applicant has ownership or beneficial interest

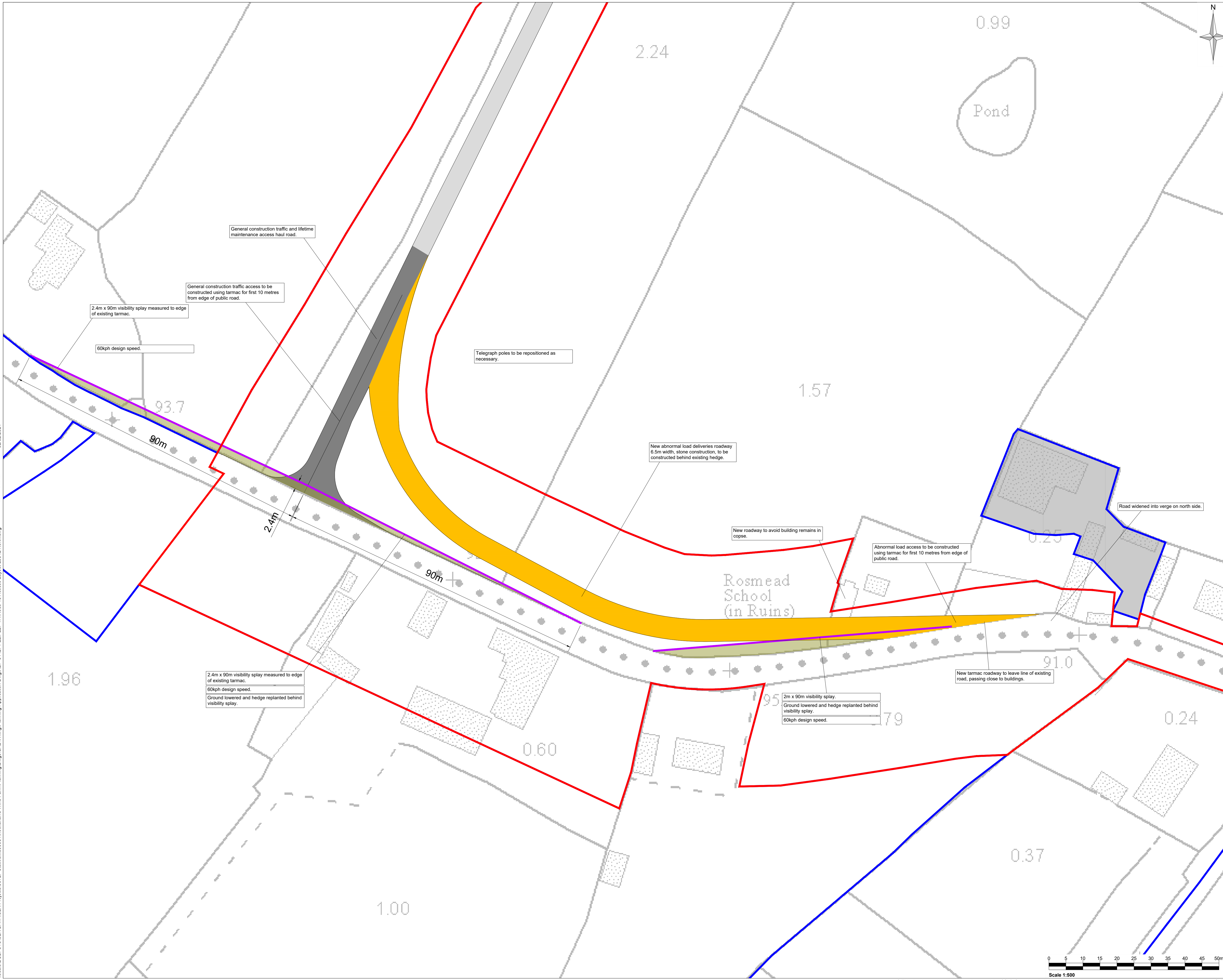

| | | | | | |
|-----|-----------------|----------|----|-----|------|
| 4 | General Updates | 25/01/24 | LB | DK | AOB |
| Rev | Amendments | Date | By | Chk | Auth |



Drawing Status & Suitability Code

Client
 Knockanarragh Wind Farm Ltd.

Project
 Knockanarragh Wind Farm

Drawing Title
 Node 13 - L5542 Site Access North

| | | | | |
|----------|-------|-------|-----------------|-----------------|
| Scale | 1:500 | @ A1 | SLR Project No. | 501.00727.00008 |
| Designed | DPP | Drawn | Checked | Authorised |
| Date | 08/23 | Date | 10/23 | Date |

| | | | |
|----------------|----------------------|-----|---|
| Drawing Number | ABP-314271-22.PL27-1 | Rev | 4 |
|----------------|----------------------|-----|---|

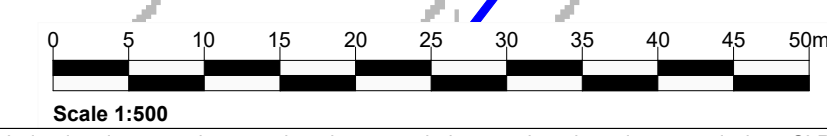

02/02/2024
 \\nafile\dibf\slr\DATA\SLR Projects\0727 Stalkart\0008 Knockanarragh Wind Farm\Planning\Drawings\CAD\Wing\Planning Application Dwg\ABP-314271-22.PL27-1_4.Node 13 Access Layout.L5542 North.dwg